



Hollow Wall Anchor

DESCRIPTION

The Hollow Wall anchor is a light duty screw type expansion anchor designed specifically for fastening to cavity walls, constructed of drywall, plaster or wallboard

TYPICAL APPLICATION

- ✓ Wall-mounted cabinets
- ✓ Storage shelves
- ✓ Book shelves
- ✓ TV mounts
- ✓ Radiators
- ✓ Wash basins
- ✓ Electrical installations
- ✓ HVAC and plumbing fixings
- ✓ Sanitary fixings

FEATURES

- One piece stamping, with integral thread and flange for increased reliability.
- Hinged legs designed to maximise load-bearing capacity
- Fixtures can be removed and re-fitted
- Integral anti-rotation lugs
- Large contact area of expanded arms increases load-bearing capacity and security

MATERIAL SPECIFICATION

- Material: Carbon Steel Q 235
- Corrosion protection: Zinc plating

ANCHOR SELECTION

Part No.	Size	Screw Dia	Screw Length (mm)	Drill Dia (mm)	Box (pcs)
600604020	4 × 20	M4	20	8	100
600604032	4 × 32	M4	32	8	100
600604038	4 × 38	M4	38	8	100
600604046	4 × 46	M4	46	8	100
600604054	4 × 54	M4	54	8	100
600604060	4 × 60	M4	60	8	100
600605037	5 × 37	M5	37	10	100
600605038	5 × 52	M5	52	10	100
600605065	5 × 65	M5	65	10	100
600605080	5 × 80	M5	80	10	100
600606037	6 × 37	M6	37	12	100
600606052	6 × 52	M6	52	12	100
600606065	6 × 65	M6	65	12	50
600606080	6 × 80	M6	70	12	50

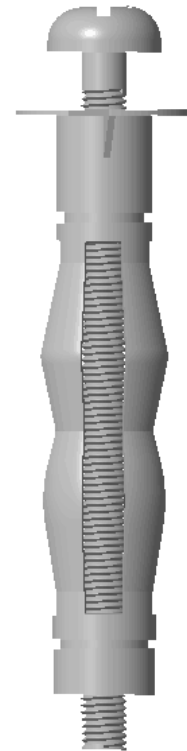

Hollow Wall Anchor



INSTALLATION

Size	d (mm)	L (mm)	d ₀ (mm)	Grip range(mm)
4 × 20	M4	20	8	1-4
4 × 32	M4	32	8	3-9
4 × 38	M4	38	8	8-15
4 × 46	M4	46	8	16-21
4 × 54	M4	54	8	18-28
4 × 60	M4	60	8	32-38
5 × 37	M5	37	10	6-13
5 × 52	M5	52	10	3-16
5 × 65	M5	65	10	14-32
5 × 80	M5	80	10	28-45
6 × 37	M6	37	12	6-13
6 × 52	M6	52	12	3-16
6 × 65	M6	65	12	14-32
6 × 80	M6	80	12	28-45

* d = Anchor diameter, L= Total length, d₀= Drill hole diameter

